

ACADEMIC CAMPUS

300 The Fenway
Boston, Massachusetts 02115
617-521-2000

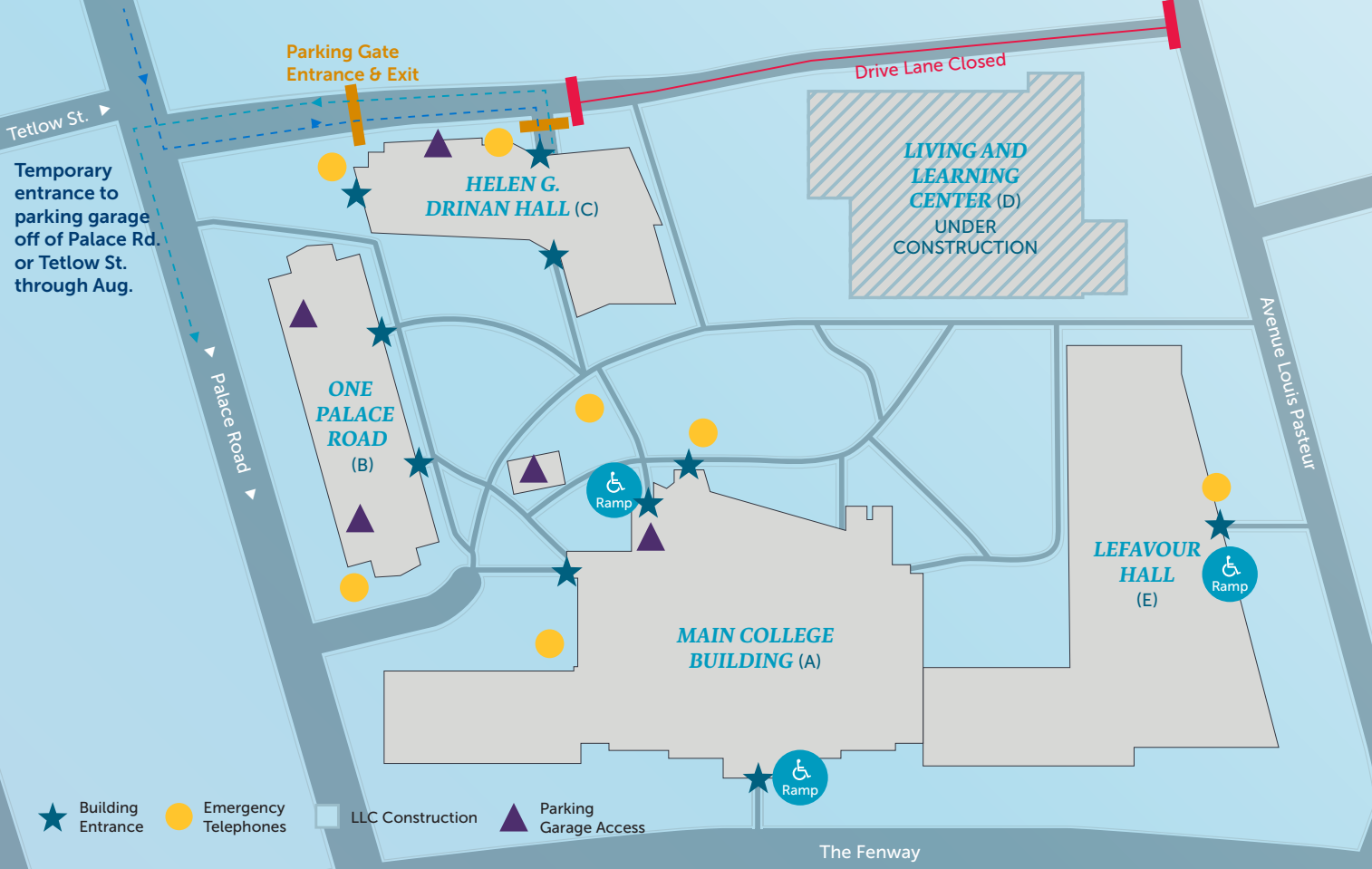

HELEN G. DRINAN HALL (C) CONTINUED

- Floor 3** School of Library and Information Science (SLIS)
- Floor 4** School of Management (SOM)
School of Social Work (SSW)
- Floor 5** Undergraduate Admission

LIVING AND LEARNING CENTER (D)

The Living and Learning Center is currently under construction and is projected to be completed in fall 2026.

LEFAVOUR HALL (E)

- Floor G** Center for Student Success
Kotzen Room
- Floor 1** Beatley Library and
University Archives
Study Rooms
- Floor 2** Lab Spaces
- Floor 3** Lab Spaces
Nursing Simulation Center
- Floor 4** School of Nursing (SON)
School of Sciences and Health
Professions (SSHP)
Departments: Behavior Analysis,
Biology, Chemistry, Health
Professions Education, Math-
ematics, Computing and Stat-
istics, Nutrition, Physical Therapy,
Physics, Public Health, Psychology
Dotson Bridge and Mentoring
Program

MAIN COLLEGE BUILDING (A)

- Floor G** Bookstore
Copy and Mail Center
Dix and Commuter Student Lounge,
REEF Support Center, VPEO, and
Community Resource Room
Facilities
The Fens Café (dining)
Technology Service Desk
- Floor 1** The Gwen Ifill School of Media,
Humanities, and Social Sciences
Common Grounds (café)
Department: Communications
Honors Lounge
Media Center (Alden Trust
Video Studio, Podcast Suite,
Simmons Radio)
Student Engagement, Success,
and Diversity
- Floor 2** Counseling Center
Human Resources
President's and Provost's Offices
Student Services One Stop
(Campus Card Office, Registrar,
Student Employment, Student
Financial Services, Veteran's Affairs)
- Floor 3** Boston Latin School Association (BLSA)
Center for Faculty Excellence (CFE)
Departments: Children's Literature;
Critical Race, Gender and Cultural
Studies; English; History; Literature
and Writing; Modern Languages
and Literatures; Philosophy
Linda K. Paresky Conference Center
- Floor 4** Departments: Art & Music
Film Lab & Darkroom
Music Practice Rooms
Trustman Art Gallery

ONE PALACE ROAD (B)

- Floor 1** Colleges of the Fenway Offices (COF)
Graduate Admission
Makerspace
Public Safety
- Floor 2 to 4** Massachusetts College of Pharmacy
and Health Sciences (MCPHS)

HELEN G. DRINAN HALL (C)

- Floor 1** Jennifer Eckert Center for
Leadership & Engagement
Multicultural Center
Student Lounge
- Floor 2** Advancement
Spiritual Life and Prayer Room
Veteran's Lounge

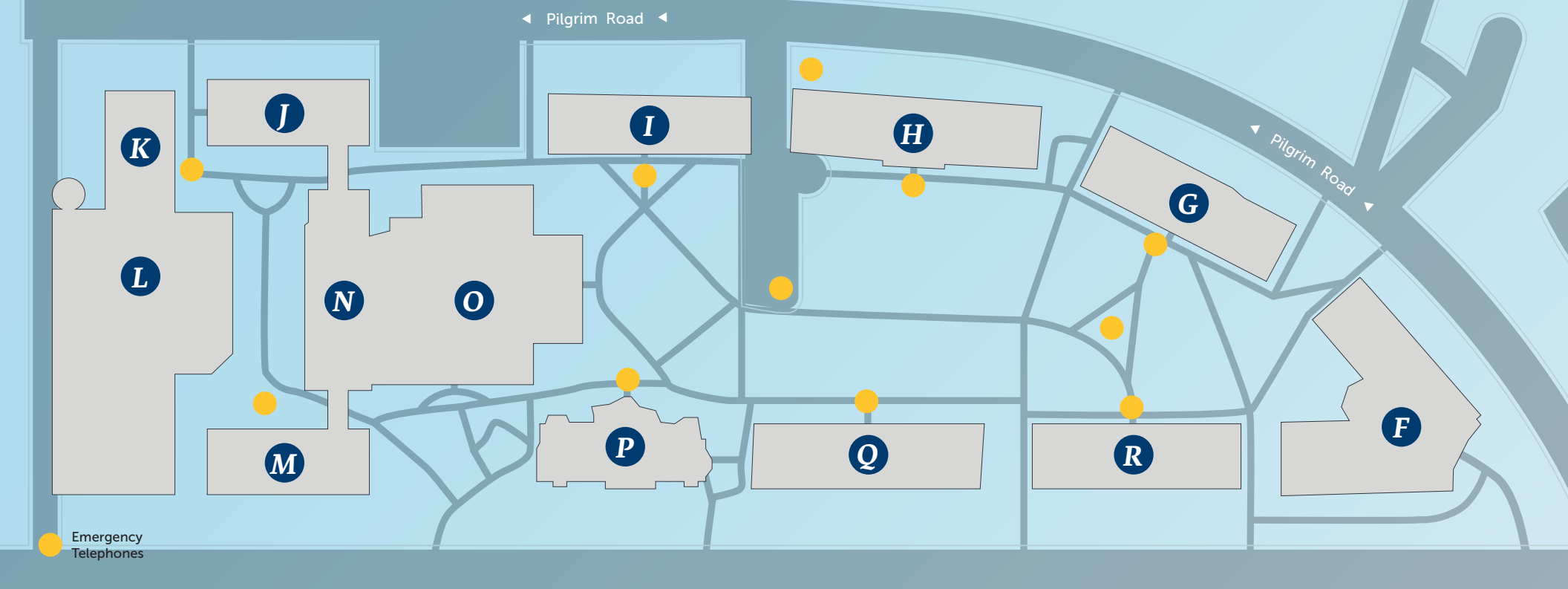

RESIDENCE CAMPUS

54 Pilgrim Road
Boston, Massachusetts 02215
617-521-1096

All public restrooms in the nine residence halls are gender-inclusive. Community restrooms are gender-inclusive for resident students.

A Public Safety officer is assigned to the Residence Campus 24/7, either in the Public Safety Booth in Simmons Hall or walking the Residence Campus grounds.

F

Simmons Hall

G

Dix Hall

H

Smith Hall

Mailroom
Prayer Room
Quadside Vending Machines
Wellness Vending Machine

I

Arnold Hall

J

North Hall

K

Health Center / Residence Life

Health Appointments
1st and 2nd Floor, Gender-Inclusive Restrooms

L

Holmes Sports Center

Fitness Center and Machines
Indoor Running Area
Swimming Pool
Yoga, Spin, Dance Classes
(and more)
Weight Room
Basketball / Volleyball Courts
2nd Floor, Gender-Inclusive Restroom

M

South Hall

N

Alumnae Hall

Auditorium

O

Bartol Dining Hall

1st Floor, Gender-Inclusive Restroom

P

Evans Hall

Affinity Student Organization Spaces

Q

Mesick Hall

R

Morse Hall